



OTTONE

www.ottone.pl



PL

Zawory odcinające

EN

Lockshields

PL

Zawory termostatyczne zasilające

EN

Thermostatizable and thermostatic

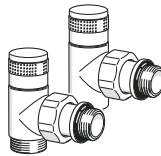

Art.
0673 - 0670

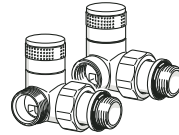

Art.
0678 - 0676

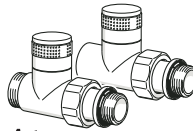

Art.
0675 - 0672

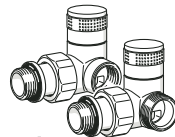

Art.
0677 - 0679

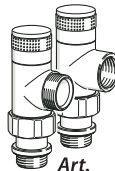

Art.
0674 - 0671

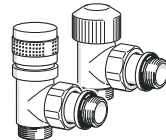

Art.
0613 - 0633
0610 - 0640

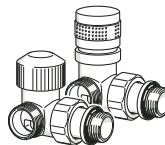

Art.
0479 - 0619
0477 - 0617

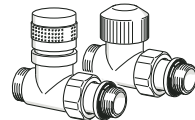

Art.
0615 - 0635
0612 - 0632

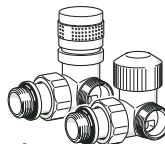

Art.
0618 - 0478
0616 - 0469

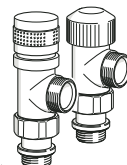

Art.
0614 - 0634
0611 - 0631

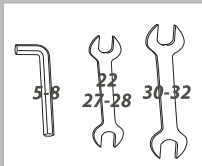
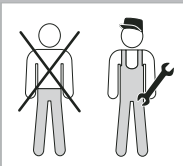



Art. 0481

ø 15



Art. 0483

ø 11.5/12-16



2 - 130° C (36-266° F)
Max 10 bar (145 psi)



Zawory odcinające/Lockshield valves

Konopie - PTFE (Telefon)
Hemp - PTFE (Telefon)

1

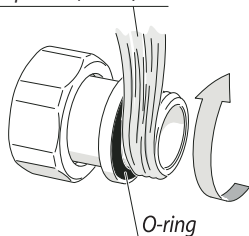

2

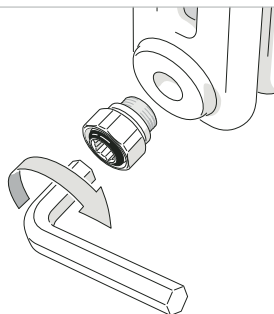

3

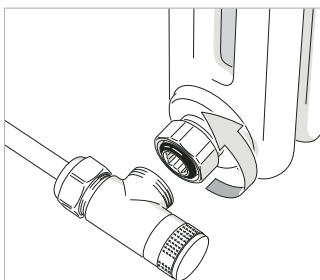

4

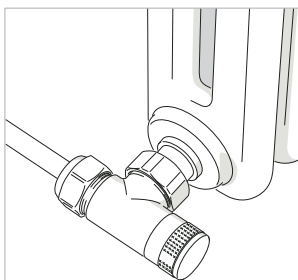

5

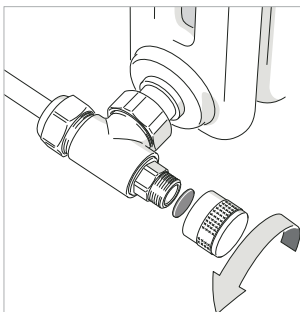

6

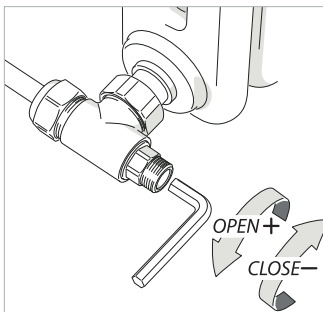



Art. 0670-0673-0671-0674

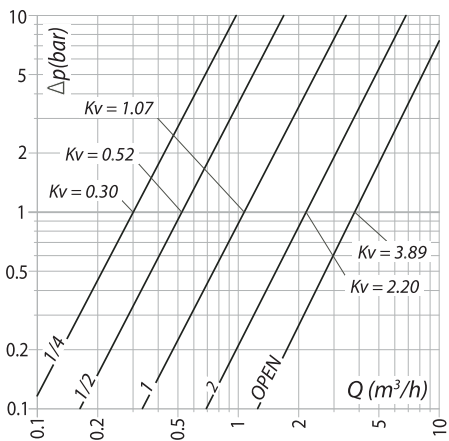

Art. 0672-0675-0676-0678-0677-0679

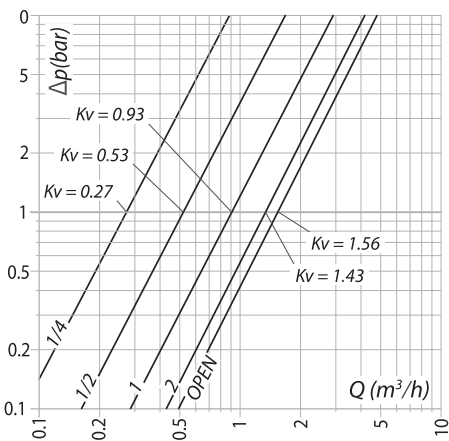

2 - 130° C (36-266° F)
Max 10 bar (145 psi)



Zawory termostatyczne zasilające/Thermostatizable and thermostatic

Konopia - PTFE (Telefon)
Hemp - PTFE (Telefon)

1

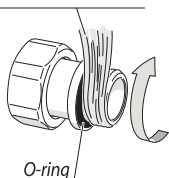

O-ring

2

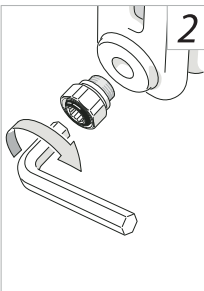

3

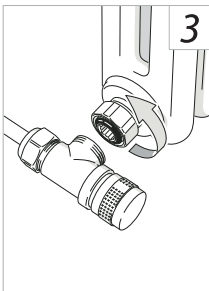

4

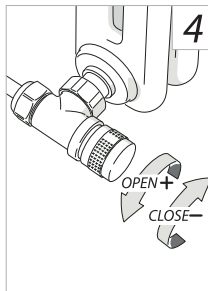

Art. 0093

1

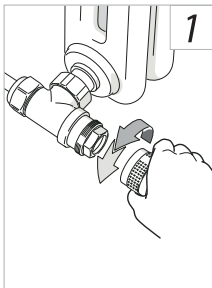

2

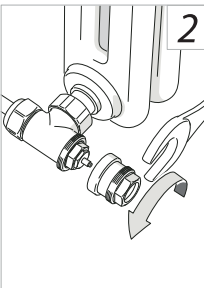

3

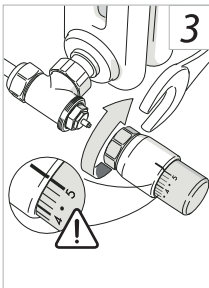

4

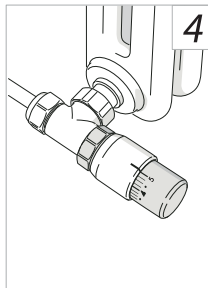



12

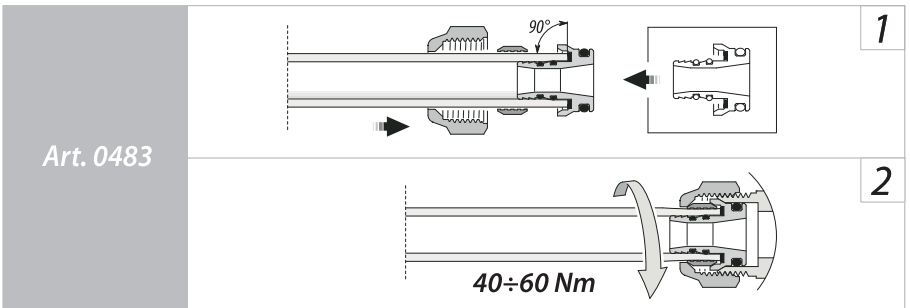
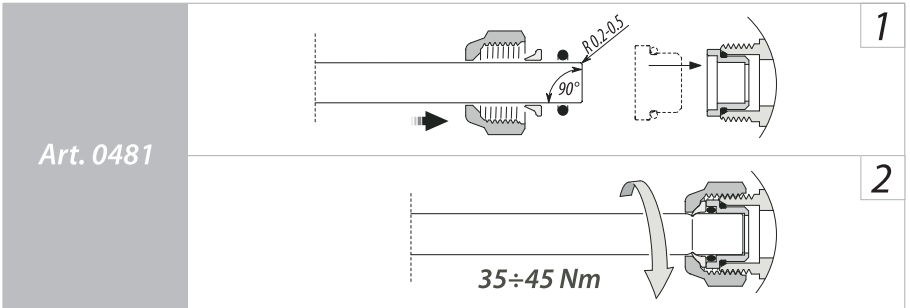
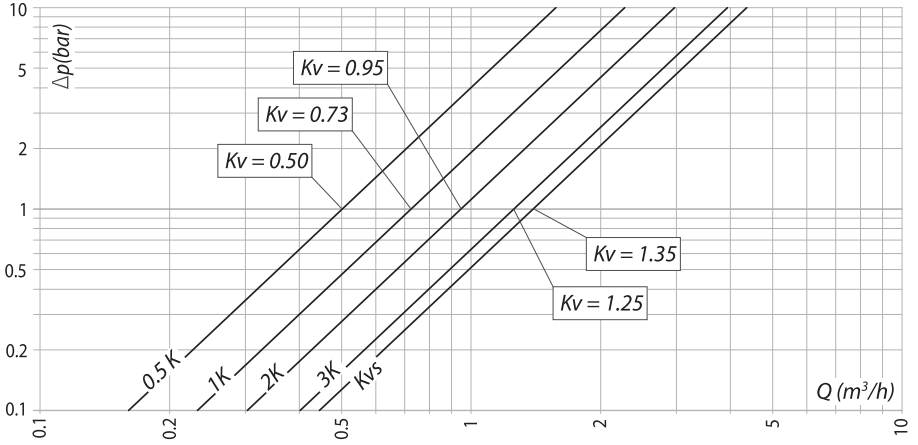

www.OTTONE.pl

OTTONE

Dystrybutor i gwarant:
Ottone spółka z ograniczoną odpowiedzialnością sp. k.
 Głogoczków 996, 32-444 Głogoczków
 tel.: 600 892 333 • biuro@ottone.pl